



PROOFMASTER™

Handproofers and Accessories



PROOFMASTER™

Handproofers and Accessories

Thank you for your interest in Pamarco Global Graphics products. The Pamarco ProofMaster™ Handproofers are industry standards, second to none for experimental and laboratory proofing of flexo inks and other fluid coating and coloring materials, on all surfaces: Polyethylene, Cellophane, Glassine, Metallic Foils, Plastic Films, Paper and Paperboard.

Quick Change™



Chrome 250 LPI to Laser 360 LPI to Laser 440 LPI in seconds!

Pamarco is proud to introduce the Pamarco *Quick Change™* Handproofing system. The *Quick Change™* is the result of years of development and working with the people who use handproofers to develop a handproofing system to handle their specific needs. Pull back once the rolls are disengaged. Pull back a second time and the roll cartridge can come right out. The "easy grab" tab allows you to remove the roll cartridge and insert the next one quickly and cleanly when you need to fine-tune your proofs.

All Pamarco Handproofers are loaded with features:

- **CUTTING EDGE TECHNOLOGY**
While the *EVENFLO* roll is a mechanically engraved chrome roll, has long been accepted as the standard for proofing, the *LASERFLO* roll is a ceramic coated and laser engraved roll capable of higher screen counts that duplicates the technology used on your press rolls today.
- **HIGH QUALITY**
The same quality standards that go into the manufacture of our full size press rolls are used here. The result is a proofer that will give consistent proofs and years of trouble free service.
- **EASE OF USE**
The Pamarco ProofMaster™ Precision Handproofers feature a compact easy to use design that makes it easy to set up and to do roll changes. In most cases it's only a matter of seconds before you are ready to go again.
- **QUICK DELIVERIES**
Many items are kept in stock and are ready to be delivered to you— Most within 24 hours.

PROOFMASTER™

Quick Change™ Handproofers

ITEM

730 *Quick Change™* COMPLETE HANDPROOFER
EVENFlo MECHANICAL ANILOX ROLL & RUBBER ROLL



731 *Quick Change™* COMPLETE HANDPROOFER
LASERFlo LASER ANILOX ROLL & RUBBER ROLL

732 *Quick Change™* STARTER KIT - HANDPROOFER
WITH 3 *EVENFlo* MECHANICAL ANILOX ROLL ASSEMBLIES



733 *Quick Change™* STARTER KIT - HANDPROOFER
WITH 3 *LASERFlo* LASER ANILOX ROLL ASSEMBLIES

734 *Quick Change™* ROLL CARRIAGE (WITH BEARINGS)
WITH 3 *EVENFlo* MECHANICAL ANILOX ROLL ASSEMBLIES



735 *Quick Change™* HANDLE ONLY
(NO ROLL CARRIAGE OR ROLLS)

Handproofers and Accessories

ITEM

704 COMPLETE STANDARD HANDPROOFER
EVENFlo MECHANICAL ANILOX ROLL & RUBBER ROLL



691 COMPLETE STANDARD HANDPROOFER
LASERFlo LASER ANILOX ROLL & RUBBER ROLL

695 STANDARD HANDLE ONLY
(NO ROLL CARRIAGE OR ROLLS)

705 COMPLETE ROTO PROOFER
EVENFlo ANILOX ROLL, NEOPRENE PAD, STEEL DR. BLADE
AND PARTS— NO RUBBER ROLL



692 COMPLETE ROTO PROOFER
LASERFlo ANILOX ROLL, NEOPRENE PAD, DR. BLADE
AND PARTS— NO RUBBER ROLL

702 *EVENFlo* MECHANICALLY ENGRAVED ANILOX ROLL
(ANY ENGRAVING FROM OUR LIST)



690 *LASERFlo* LASER ENGRAVED ANILOX ROLL
(ANY *LASERFlo* ENGRAVING)



703 RUBBER ROLLS
(50/55 OR 70/75 DUROMETER)



701 PRECISION PROOFER MACHINE
Use the Precision Proofer to create accurate, repeatable film thickness impressions on a complete spectrum of substrates. Based on an air-driven technology, the unit has a repeatable and adjustable proofing cycle. It also eliminates the variables of hand proofing—always giving the same speed, impression, anilox setting and film thickness readings as calibrated—So you have the exact QC/SPC required from proof to proof.



- 725 DOCTOR BLADE ASSEMBLY
MOUNTS ON YOUR *Quick Change™* OR STANDARD
HANDPROOFER
- 726 SPARE DOCTOR BLADES
(ROTOPROOFER AND DOCTOR BLADE ASSEMBLY)
- 696 BEARING SET (2 UPPER OR 2 LOWER)
UPPER FOR RUBBER ROLLER
697 LOWER FOR ANILOX ROLLER
- 698 SPRINGS
- 699 NEOPRENE IMPRESSION PAD



PROOFMASTER™

Accessories

KEEP YOUR PROOFER CLEAN

Pamarco Global Graphics recognizes how important it is to keep your handproofers clean for optimal performance. Attractively priced, our cleaners are safe, environmentally friendly and designed to work on the handproofers, rubber and anilox rolls. For Water, Solvent or UV applications.

ITEM

- 665A CARE™ PAD
Cleaning aid specifically designed to penetrate deep into each anilox cell and provide maximum cleaning on even the most stubborn ink residues. *(Discounts apply for quantity purchases)*



- 708 PLATE BRUSHES



- 706 BRASS BRISTLE BRUSHES
FOR CHROME ROLLS



- 707 STAINLESS STEEL BRUSHES
FOR LASER AND CERAMIC ROLLS



- 727 HANDHELD MICROSCOPE (200X, 300X or 400X)
The Pamarco Handheld Microscope allows for quick on-the-spot inspection of your anilox rolls and plates. Ideal for troubleshooting, simple to use and featuring ruggedized construction, the Handheld Microscope is ideally suited for the demands of the pressroom.



PROOFMASTER™

Replacement Parts

REPLACEMENT PARTS
REPLACEMENT PARTS ARE AVAILABLE—CONTACT US FOR PRICING

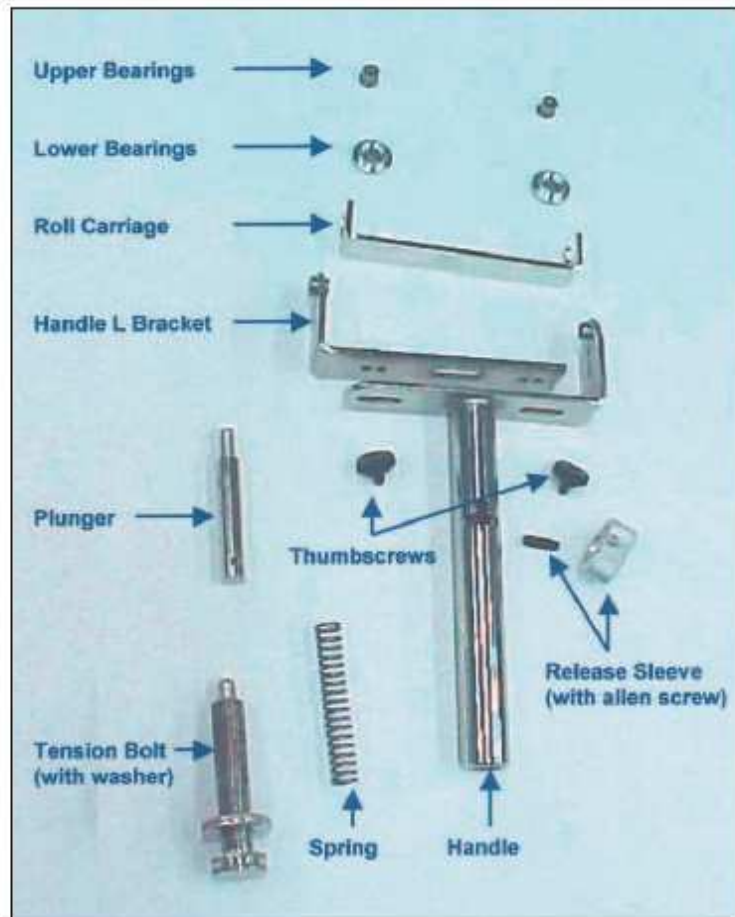

LASERFLO and EVENFLO Engraving Charts

LASERFLO Engravings

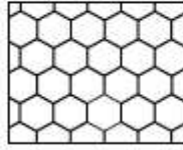

LINESCREEN		VOLUME	
Per Inch	(per CM)	BCM/in ²	(cm ² /m ²)
165	(65)	9.4	(14.57)
180	(70)	6.8	(10.54)
200	(80)	7.9	(12.25)
250	(100)	7.2	(11.16)
300	(120)	4.5	(6.98)
360	(140)	5.0	(7.75)
400	(160)	3.7	(5.74)
550	(220)	2.7	(4.19)
600	(240)	2.5	(3.88)
700	(280)	2.2	(3.41)
800	(320)	1.8	(2.79)

Other linescreens and volumes are available from 120LPI to 800 LPI

EVENFLO Mechanical Engraving Screen Selection Chart

ROTO-FLO QUAD



Tool Ref.	LPI	Depth	Min. Volume	Max. Volume
149	280	16.1	5.24	5.68
148	280	27.1	6.38	7.25
165	250	21.9	5.53	6.28
170	250	27.4	6.60	7.50
156	200	24.2	6.17	7.02
106	200	36.6	8.02	9.12
173	200	53.5	11.87	13.51
137	180	36.6	6.32	7.41
142	145	44.9	10.72	12.19
167	150	39.1	12.44	14.14
171	150	60.2	14.50	16.48
158	140	56.0	12.65	14.36
143	140	70.0	15.44	20.15
146	120	97.4	22.96	26.09
134	100	86.7	20.03	23.26
164	85	133.3	30.20	33.56
140	55	145.0	34.31	38.13
148	35	173.0	42.04	46.71
124	45	155.0	49.76	55.21
107	40	170.0	56.12	62.36
175	25	280.0	80.27	89.21

ROTO-FLO PYRAMID



Tool Ref.	LPI	Depth	Min. Volume	Max. Volume
148	420	16.5	2.72	3.20
136	360	19.5	2.88	3.39
150	360	22.2	6.02	7.08
137	280	34.5	6.21	7.06
142	250	34.0	6.65	7.55
120	200	43.2	8.00	9.09
117	180	45.5	10.33	11.74
126	165	59.6	11.51	13.08
167	150	74.6	13.53	15.37
130	140	66.2	11.80	13.41
151	120	109.4	16.27	18.52
131	100	109.2	15.91	17.68
157	85	103.0	18.46	20.53

EVENFLO Mechanical Engraving Screen Selection Chart, cont.

PYRAMID

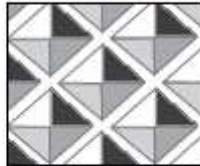

Tool Ref.	LPI	Depth	Min. Volume	Max. Volume
129	-	600	10.9	1.77
2	-	550	19.5	2.88
150	-	360	6.2	1.31
27	-	400	11.7	2.39
44	-	360	13.3	2.31
113	-	360	15.9	2.80
98	-	360	21.8	4.33
87	-	300	16.4	3.03
20	-	250	21.7	3.23
39	-	250	24.3	5.52
53	-	220	27.1	4.85
66	-	200	23.5	4.57
34	-	180	21.8	4.11
49	-	180	25.5	5.26
14	-	165	41.0	8.78
63	-	165	59.7	11.74
61	-	150	42.2	8.29
76	-	140	74.5	14.47
50	-	130	46.9	9.89
90	-	120	66.1	13.27
9	-	110	67.3	13.86
88	-	100	81.7	16.09
41	-	88	105.4	20.02
56	-	75	120.0	22.72
5	-	70	98.2	28.87
30	-	65	150.3	30.09
89	-	60	157.9	30.08
64	-	55	152.8	30.55
25	-	50	178.0	35.18
81	-	44	215.0	42.78
15	-	36	300.0	59.49
59	-	28	365.0	73.39
18	-	24	365.0	72.08
161	-	20	420.0	72.77
38	-	20	510.0	99.52
51	-	16	650.0	125.17
60	-	12	885.0	167.36
36	-	7.5	1200.00	284.64

EVENFLO Mechanical Engraving Screen Selection Chart, cont.

QUAD

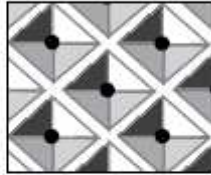

Tool Ref.	µm	Depth	Min. Volume	Max. Volume
63	200	31.6	6.63	7.53
106	200	40.6	8.35	9.49
90	180	36.7	5.14	10.39
33	180	49.0	14.20	16.13
13	165	55.0	14.23	16.17
71	150	55.2	14.09	16.01
204	150	80.8	19.24	20.73
18	140	81.5	22.82	25.93
15	125	147.3	12.67	14.40
43	120	78.2	16.95	19.26
16	130	78.0	19.05	21.65
94	120	94.8	19.74	22.43
35	110	89.2	18.27	20.77
46	110	87.6	20.25	23.01
12	100	134.0	27.31	30.34
7	95	106.7	29.06	32.29
55	85	102.2	27.09	30.10
152	85	117.3	29.18	32.42
47	75	139.0	34.84	38.71
8	70	133.5	26.18	29.09
33	65	106.2	35.16	39.07
54	65	186.3	43.32	48.13
77	55	133.7	39.53	43.92
51	55	210.0	48.36	53.73
153	45	172.0	48.19	53.55
65	45	173.0	53.04	58.93
159	35	186.0	60.25	66.94
24	35	235.0	75.94	84.38
73	30	215.0	80.07	88.96
90	25	382.0	84.70	94.11
11	25	315.0	95.10	105.67
68	20	365.0	128.86	143.18
42	17	425.0	149.21	165.79
48	16	675.0	168.48	188.31
86	10	375.0	156.93	174.37
78	10	500.0	189.62	210.69

EVENFLO Mechanical Engraving Screen Selection Chart, cont.

TRI HELICAL

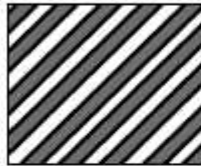

Tool Ref.	LPI	Depth	Min. Volume	Max. Volume
6	200	19.2	5.13	5.83
118	200	31.1	7.63	8.67
95	180	33.2	6.38	9.52
58	180	36.6	10.69	12.15
102-F	180	60.4	16.18	18.39
34	150	53.0	15.23	17.31
106-F	145	90.2	23.71	26.94
67	140	37.5	10.29	11.69
23	120	55.3	14.36	16.31
22	120	69.2	20.45	23.24
49	110	69.2	19.19	21.81
107	100	55.7	15.53	17.26
11	100	85.8	24.27	26.97
47	95	94.6	28.33	31.50
85	90	95.9	27.67	30.74
39	85	99.9	28.91	32.32
8	80	115.6	35.00	38.89
3	75	167.1	57.71	64.12
62	70	130.4	36.17	40.19
84	64	132.5	37.56	41.74
29	60	140.4	40.10	44.56
88	60	157.8	43.84	48.71
43	55	167.0	47.85	53.17
38	50	194.0	57.00	63.33
27	45	174.0	51.05	56.72
12	45	200.0	57.25	63.61
54	42	187.0	52.25	58.05
61	38	166.0	47.90	53.22
83	35	275.0	76.43	84.92
55	35	295.0	86.23	95.81
62	30	247.0	77.39	85.99
75	30	310.0	89.59	99.54
23	28	385.0	114.07	126.74
26	25	377.0	68.13	75.70
68	23	195.0	76.11	84.57
101	20	340.0	116.36	129.29
65	10	676.0	195.95	217.72



SIMONAZZI s.r.l.

Sede Amministrativa e Magazzino

20060 PESSANO con BORNAGO (MI) - Via Aldo Moro, 5/7/9

Tel.: +39.02.95.74.90.73 - +39.02.95.74.90.74 - Fax +39.02.95.74.99.08

Sede legale: 20125 MILANO (ITALIA) - Via Popoli Uniti, 11/13

Partita IVA IT 07750010154 - www.simonazzi.it