



PROOFMASTER™

Handproofers and Accessories



PROOFMASTER™

Handproofers and Accessories

Thank you for your interest in Pamarco Global Graphics products. The Pamarco ProofMaster™ Handproofer are industry standards, second to none for experimental and laboratory proofing of flexo inks and other fluid coating and coloring materials, on all surfaces: Polyethylene, Cellophane, Glassine, Metallic Foils, Plastic Films, Paper and Paperboard.

Quick Change™



Chrome 250 LPI to Laser 360 LPI to Laser 440 LPI *in seconds!*

Pamarco is proud to introduce the Pamarco *Quick Change™* Handproofer. The *Quick Change™* is the result of years of development and working with the people who use handproofers to develop a handproofing system to handle their specific needs. Pull back once the rolls are disengaged. Pull back a second time and the roll carriage can come right out. The "easy grab" tab allows you to remove the roll carriage and insert the next one quickly and cleanly when you need to fine-tune your proofs.

All Pamarco Handproofers are loaded with features:

- **CUTTING EDGE TECHNOLOGY**
While the *EVENFLO* roll a mechanically engraved chrome roll, has long been accepted as the standard for proofing, the *LASERFLO* roll is a ceramic coated and laser engraved roll capable of higher screen counts that duplicates the technology used on your press rolls today.
- **HIGH QUALITY**
The same quality standards that go into the manufacture of our full size press rolls are used here. The result is a proofer that will give consistent proofs and years of trouble free service.
- **EASE OF USE**
The Pamarco ProofMaster™ Precision Handproofers feature a compact easy to use design that makes it easy to set up and to do roll changes. In most cases it's only a matter of seconds before you are ready to go again.
- **QUICK DELIVERIES**
Many items are kept in stock and are ready to be delivered to you— Most within 24 hours.

PROOFMASTER™

Quick Change™ Handproofers

ITEM

730 *Quick Change™* COMPLETE HANDPROOFER
EVENFlo MECHANICAL ANILOX ROLL & RUBBER ROLL



731 *Quick Change™* COMPLETE HANDPROOFER
LASERFlo LASER ANILOX ROLL & RUBBER ROLL

732 *Quick Change™* STARTER KIT - HANDPROOFER
WITH 3 *EVENFlo* MECHANICAL ANILOX ROLL ASSEMBLIES



733 *Quick Change™* STARTER KIT - HANDPROOFER
WITH 3 *LASERFlo* LASER ANILOX ROLL ASSEMBLIES

734 *Quick Change™* ROLL CARRIAGE (WITH BEARINGS)
WITH 3 *EVENFlo* MECHANICAL ANILOX ROLL ASSEMBLIES



735 *Quick Change™* HANDLE ONLY
(NO ROLL CARRIAGE OR ROLLS)

Handproofers and Accessories

ITEM

704 COMPLETE STANDARD HANDPROOFER
EVENFlo MECHANICAL ANILOX ROLL & RUBBER ROLL



691 COMPLETE STANDARD HANDPROOFER
LASERFlo LASER ANILOX ROLL & RUBBER ROLL

695 STANDARD HANDLE ONLY
(NO ROLL CARRIAGE OR ROLLS)

705 COMPLETE ROTO PROOFER
EVENFlo ANILOX ROLL, NEOPRENE PAD, STEEL DR. BLADE
AND PARTS— NO RUBBER ROLL



692 COMPLETE ROTO PROOFER
LASERFlo ANILOX ROLL, NEOPRENE PAD, DR. BLADE
AND PARTS— NO RUBBER ROLL

702 *EVENFlo* MECHANICALLY ENGRAVED ANILOX ROLL
(ANY ENGRAVING FROM OUR LIST)



690 *LASERFlo* LASER ENGRAVED ANILOX ROLL
(ANY *LASERFlo* ENGRAVING)



703 RUBBER ROLLS
(50/55 OR 70/75 DUROMETER)



701 PRECISION PROOFER MACHINE
Use the Precision Proofer to create accurate, repeatable film thickness impressions on a complete spectrum of substrates. Based on an air-driven technology, the unit has a repeatable and adjustable proofing cycle. It also eliminates the variables of hand proofing—always giving the same speed, impression, anilox setting and film thickness readings as calibrated—So you have the exact QC/SPC required from proof to proof.



- 725 DOCTOR BLADE ASSEMBLY
MOUNTS ON YOUR *Quick Change™* OR STANDARD
HANDPROOFER
- 726 SPARE DOCTOR BLADES
(ROTOPROOFER AND DOCTOR BLADE ASSEMBLY)
- 696 BEARING SET (2 UPPER OR 2 LOWER)
UPPER FOR RUBBER ROLLER
697 LOWER FOR ANILOX ROLLER
- 698 SPRINGS
- 699 NEOPRENE IMPRESSION PAD



PROOFMASTER™

Accessories

KEEP YOUR PROOFER CLEAN

Pamarco Global Graphics recognizes how important it is to keep your handproofers clean for optimal performance. Attractively priced, our cleaners are safe, environmentally friendly and designed to work on the handproofers, rubber and anilox rolls. For Water, Solvent or UV applications.

ITEM

- 665A CARE™ PAD
Cleaning aid specifically designed to penetrate deep into each anilox cell and provide maximum cleaning on even the most stubborn ink residues. *(Discounts apply for quantity purchases)*



- 708 PLATE BRUSHES



- 706 BRASS BRISTLE BRUSHES
FOR CHROME ROLLS



- 707 STAINLESS STEEL BRUSHES
FOR LASER AND CERAMIC ROLLS



- 727 HANDHELD MICROSCOPE (200X, 300X or 400X)
The Pamarco Handheld Microscope allows for quick on-the-spot inspection of your anilox rolls and plates. Ideal for troubleshooting, simple to use and featuring ruggedized construction, the Handheld Microscope is ideally suited for the demands of the pressroom.



PROOFMASTER™

Replacement Parts

REPLACEMENT PARTS
REPLACEMENT PARTS ARE AVAILABLE—CONTACT US FOR PRICING

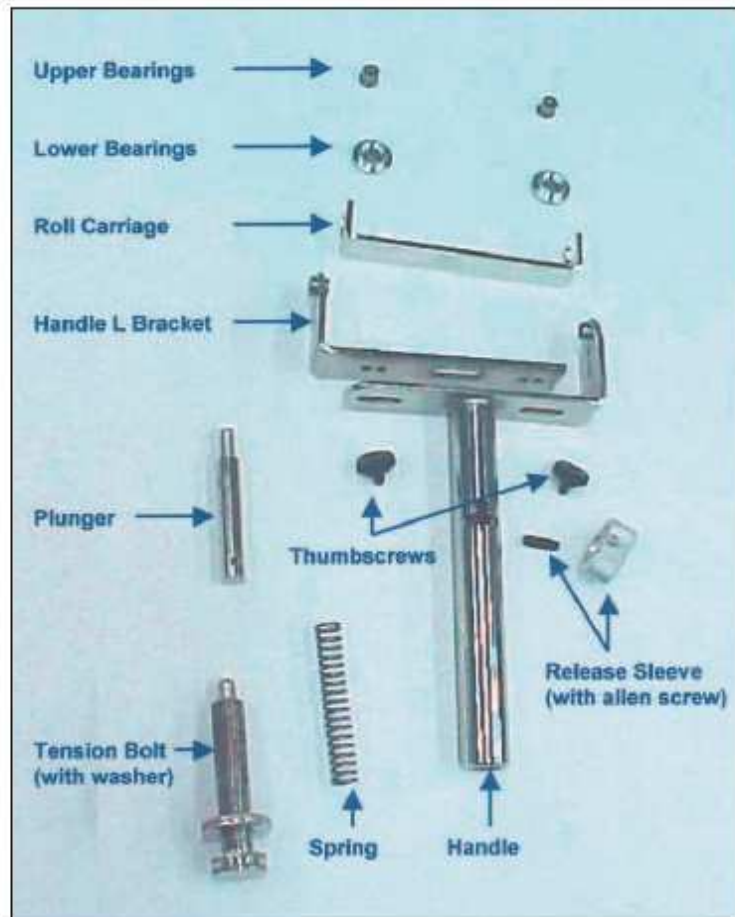

LASERFLO and EVENFLO Engraving Charts

LASERFLO Engravings

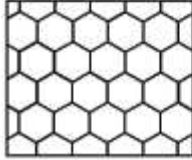

LINESCREEN		VOLUME	
Per Inch	(per CM)	BCM/in ²	(cm ³ /m ²)
165	(65)	9.4	(14.57)
180	(70)	6.8	(10.54)
200	(80)	7.9	(12.25)
250	(100)	7.2	(11.16)
300	(120)	4.5	(6.98)
360	(140)	5.0	(7.75)
400	(160)	3.7	(5.74)
550	(220)	2.7	(4.19)
600	(240)	2.5	(3.88)
700	(280)	2.2	(3.41)
800	(320)	1.8	(2.79)

Other linescreens and volumes are available from 120LPI to 800 LPI

EVENFLO Mechanical Engraving Screen Selection Chart

ROTO-FLO QUAD



CELL COUNT	280	280	250	250	200	200	200	180	165	150	150
TOOL REF#	149	145	170	165	156	106	173	139	142	169	171
BCM	5.1	7.5	8.5	6.4	7.1	10.4	16.8	8.8	45.5	14.6	16.8
CELL COUNT	140	140	120	100	85	85	55	55	45	45	25
TOOL REF#	143	138	146	134	164	160	148	140	107	124	175
BCM	19.8	15.9	27.2	23.9	34.4	31.9	48.2	37.3	61.2	52.3	95.1

ROTO-FLO PYRAMID



CELL COUNT	420	360	360	360	280	250	200	180	165	150	140	120	100	85
TOOL REF#	168	150	116	158	137	162	120	117	126	167	130	151	131	157
BCM	3.5	6.9	4.6	3.3	7	8.2	10.2	10.2	13.6	14.4	13.3	22.3	23.8	21.1

EVENFLO Mechanical Engraving Screen Selection Chart, cont.

PYRAMID

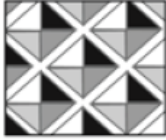

CELL COUNT	TOOL REF#	BCM
600	129	2.8
550	2	2.7
400	27	2.8
360	113	3.7
360	44	5
360	98	6.2
300	87	4.5
250	20	3.3
250	39	7.1
220	53	6.3
204	32	5.5
200	66	6.8
180	49	7.8
180	70	3.4
165	14	9.4
150	61	9.3
140	76	16
130	50	11.1
120	80	14.7
110	9	15.5
100	88	17
88	41	20.9
75	92	5.3
75	56	25
70	5	20.5
65	30	30.2
60	89	35.1
55	64	32.7
50	25	36
44	81	46.5
42	74	49.6
36	15	65.3
28	59	76.8
24	82	80
20	35	106.3
20	161	80.1
16	51	144.2
12	60	186.5
7.5	36	286.9

QUAD

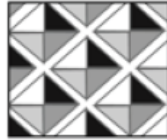

CELL COUNT	TOOL REF#	BCM
360	155	6.9
300	3	4.5
250	91	7.2
250	154	4.9
220	28	9.3
200	63	9.5
200	103	7.9
200	174	5.3
190	147	6.4
180	90	10.3
180	45	12.4
165	13	17.3
150	122	10.2
150	71	18.6
140	37	21.3
140	18	13.7
140	123	17.9
130	79	23.3
120	21	22.6
120	172	13.2
110	46	25.5
95	7	29.8
95	101	30.4
85	177	32.8
85	152	34.6
85	55	28.8
72	17	41.6
65	33	40.3
55	77	44.9
45	65	60.4
45	153	54.7
35	24	81.7
35	159	66.9
30	73	91.9
25	11	94.7
20	68	154.6
17	42	156.7
10	78	215.3
10	86	168.9

TRI HELICAL



CELL COUNT	TOOL REF#	BCM
360	95	7.7
360	104	10
230	4	5.9
200	16	12
200	118	7.7
180	96	10.3
180	58	12.2
180	114	13.5
180	102	17.7
150	34	14.7
145	97	24.1
145	108	26.4
140	67	13.5
120	22	23.2
110	69	23
95	47	28.1
90	85	26.8
85	72	30.7
80	8	36.2
70	62	36.8
64	84	40.2
60	29	44.1
55	43	49.5
50	38	62.4
45	12	64.8
38	52	80.6
35	83	84.8
30	75	98.5
28	23	114.2
24	54	137.6

Divide Cell count by 2.54
to get Lines per CM
Multiply BCM by 1.55 to get cm³/m²



SIMONAZZI

Sede Amministrativa e Magazzino

20060 PESSANO con BORNAGO (MI) - Via Aldo Moro, 5/7/9
Tel.: +39.02.95.74.90.73 - +39.02.95.74.90.74 - Fax +39.02.95.74.99.08

Sede legale: 20125 MILANO (ITALIA) - Via Popoli Uniti, 11/13
Partita IVA IT 07750010154 - www.simonazzi.it